

# MO EURO RANGE

Spring Type/ Part Number Order either <b>P</b> or <b>TH</b>	Spring Force N (lbs)		Piston Ø mm	Body Ø mm	<b>L1 P</b> Plain	<b>L2 TH</b> Tapped Holes	Service Kit
	Initial	Maximum					
MO 00500/25 <b>P</b> or <b>TH</b>	5000	7100	20	40	92	102	34-26-00
MO 00500/40 <b>P</b> or <b>TH</b>					122	132	
MO 00500/50 <b>P</b> or <b>TH</b>	(1102)	(1565)			142	152	
MO 00500/65 <b>TH</b> only					-	182	
MO 00500/80 <b>TH</b> only					-	212	
MO 00500/100 <b>TH</b> only					-	252	
MO 00500/125 <b>TH</b> only					-	302	
MO 00500/160 <b>TH</b> only					-	372	
MO 01000/25 <b>P</b> or <b>TH</b>	10000	16500	25	50	113	123	34-26-01
MO 01000/40 <b>P</b> or <b>TH</b>					143	153	
MO 01000/50 <b>P</b> or <b>TH</b>	(2240)	(3699)			163	173	
MO 01000/65 <b>TH</b> only					-	203	
MO 01000/80 <b>TH</b> only					-	233	
MO 01000/100 <b>TH</b> only					-	273	
MO 01000/125 <b>TH</b> only					-	323	
MO 01000/160 <b>TH</b> only					-	393	
MO 01750/25 <b>TH</b> only	17500	28875	36	65	-	123	34-26-02
MO 01750/40 <b>TH</b> only					-	153	
MO 01750/50 <b>TH</b> only	(3920)	(6468)			-	173	
MO 01750/65 <b>TH</b> only					-	203	
MO 01750/80 <b>TH</b> only					-	233	
MO 01750/100 <b>TH</b> only					-	273	
MO 01750/125 <b>TH</b> only					-	323	
MO 01750/160 <b>TH</b> only					-	393	
MO 02500/25 <b>TH</b> only	25000	41260	45	75	-	140	34-26-03
MO 02500/40 <b>TH</b> only					-	170	
MO 02500/50 <b>TH</b> only	(5600)	(9184)			-	190	
MO 02500/65 <b>TH</b> only					-	220	
MO 02500/80 <b>TH</b> only					-	250	
MO 02500/100 <b>TH</b> only					-	290	
MO 02500/125 <b>TH</b> only					-	340	
MO 02500/160 <b>TH</b> only					-	410	
MO 04000/25 <b>TH</b> only	40000	66000	55	95	-	145	34-26-04
MO 04000/40 <b>TH</b> only					-	175	
MO 04000/50 <b>TH</b> only	(8960)	(14784)			-	195	
MO 04000/65 <b>TH</b> only					-	225	
MO 04000/80 <b>TH</b> only					-	255	
MO 04000/100 <b>TH</b> only					-	295	
MO 04000/125 <b>TH</b> only					-	345	
MO 04000/160 <b>TH</b> only					-	415	
MO 06500/25 <b>TH</b> only	65000	10725	75	120	-	160	34-26-05
MO 06500/40 <b>TH</b> only					-	190	
MO 06500/50 <b>TH</b> only	(14560)	(24000)			-	210	
MO 06500/65 <b>TH</b> only					-	240	
MO 06500/80 <b>TH</b> only					-	270	
MO 06500/100 <b>TH</b> only					-	310	
MO 06500/125 <b>TH</b> only					-	360	
MO 06500/160 <b>TH</b> only					-	430	
MO 07500/25 <b>TH</b> only	75000	10500	80	150	-	180	34-26-06
MO 07500/40 <b>TH</b> only					-	210	
MO 07500/50 <b>TH</b> only	(16800)	(23520)			-	230	
MO 07500/65 <b>TH</b> only					-	260	
MO 07500/80 <b>TH</b> only					-	290	
MO 07500/100 <b>TH</b> only					-	330	
MO 07500/125 <b>TH</b> only					-	380	
MO 07500/160 <b>TH</b> only					-	450	
MO 12500/25 <b>TH</b> only	125000	200000	100	190	-	190	34-26-07
MO 12500/40 <b>TH</b> only					-	220	
MO 12500/50 <b>TH</b> only	(28000)	(44800)			-	240	
MO 12500/65 <b>TH</b> only					-	270	
MO 12500/80 <b>TH</b> only					-	300	
MO 12500/100 <b>TH</b> only					-	340	
MO 12500/125 <b>TH</b> only					-	390	
MO 12500/160 <b>TH</b> only					-	460	

**NB. All TH cylinders must be retained by using the tapped holes in the base, or clamping rings (CR) on page 21**



# MO EURO RANGE

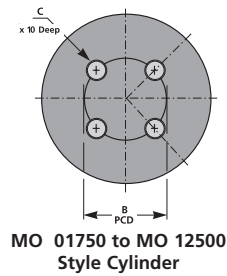
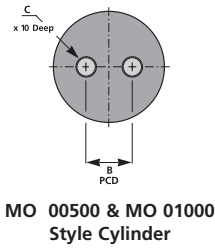
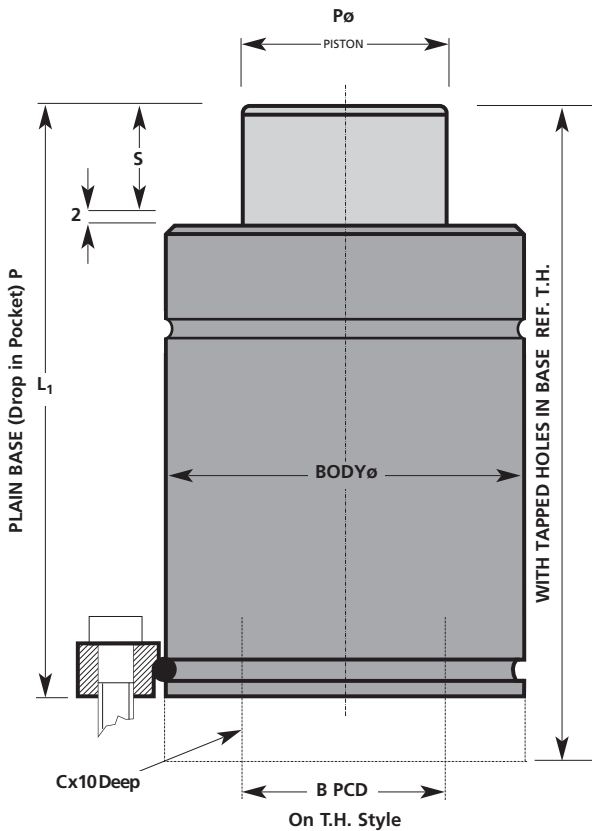

### Fixing Centres (TH Only)

Type	B	C
MO 00500	20	2xM8
MO 01000	20	2xM8
MO 01750	32	4xM8
MO 02500	40	4xM8
MO 04000	60	4xM10
MO 06500	80	4xM10
MO 07500	80	4xM10
MO 12500	100	4xM10

### GAS SPRING DATA

Use only Nitrogen.  
 Max. Pressure 150 Bar.  
 Min. Pressure 50 Bar.  
 Max. Piston Velocity 38m/min.  
 Max Side Force 0.20<sup>0</sup>  
 CNOMO Hoses by request

### FORCE ON IMPACT FOR MO RANGE

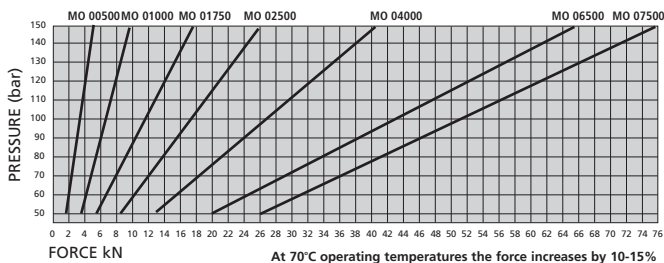

### Character curves for MO Range MO 0500, MO 1000, MO 1750, MO 2500, MO 4000, MO 6500 MO 7500 MO 12500

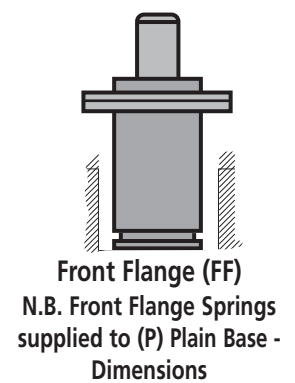
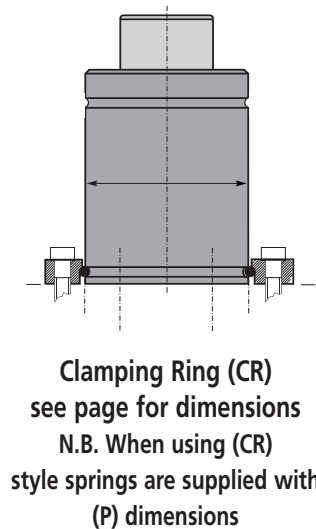
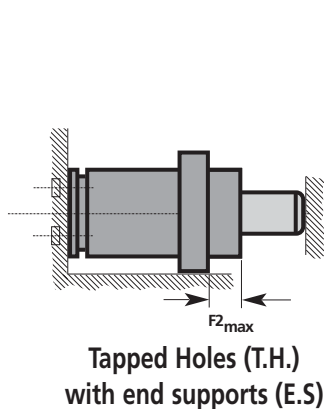
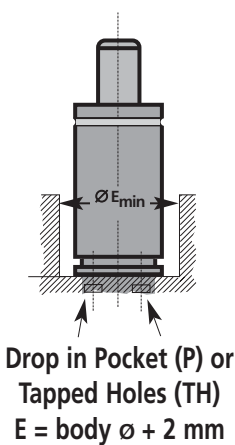
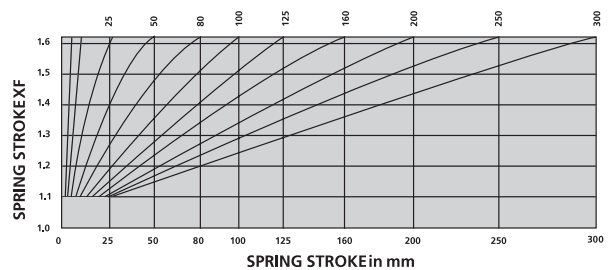

**How to Order:**  
 Spring Type x Stroke x Fixing  
 MO 01750/50CR

See pages 19 - 23 for  
 Fastening Examples.

